

Les Encombrements - configuration Ressort AVANT

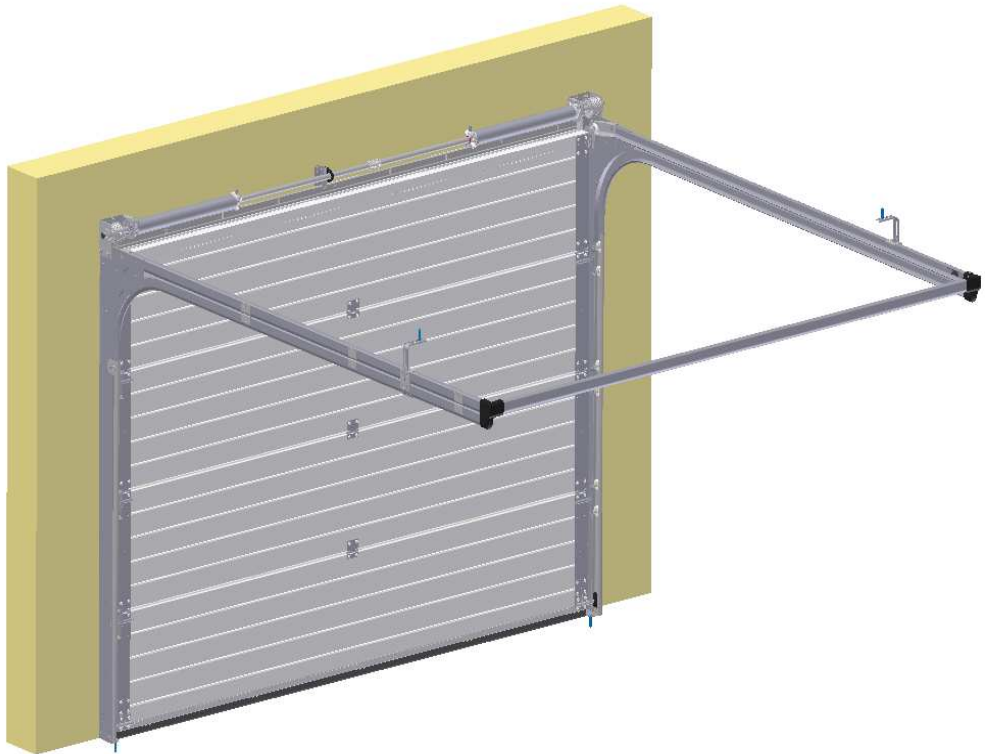

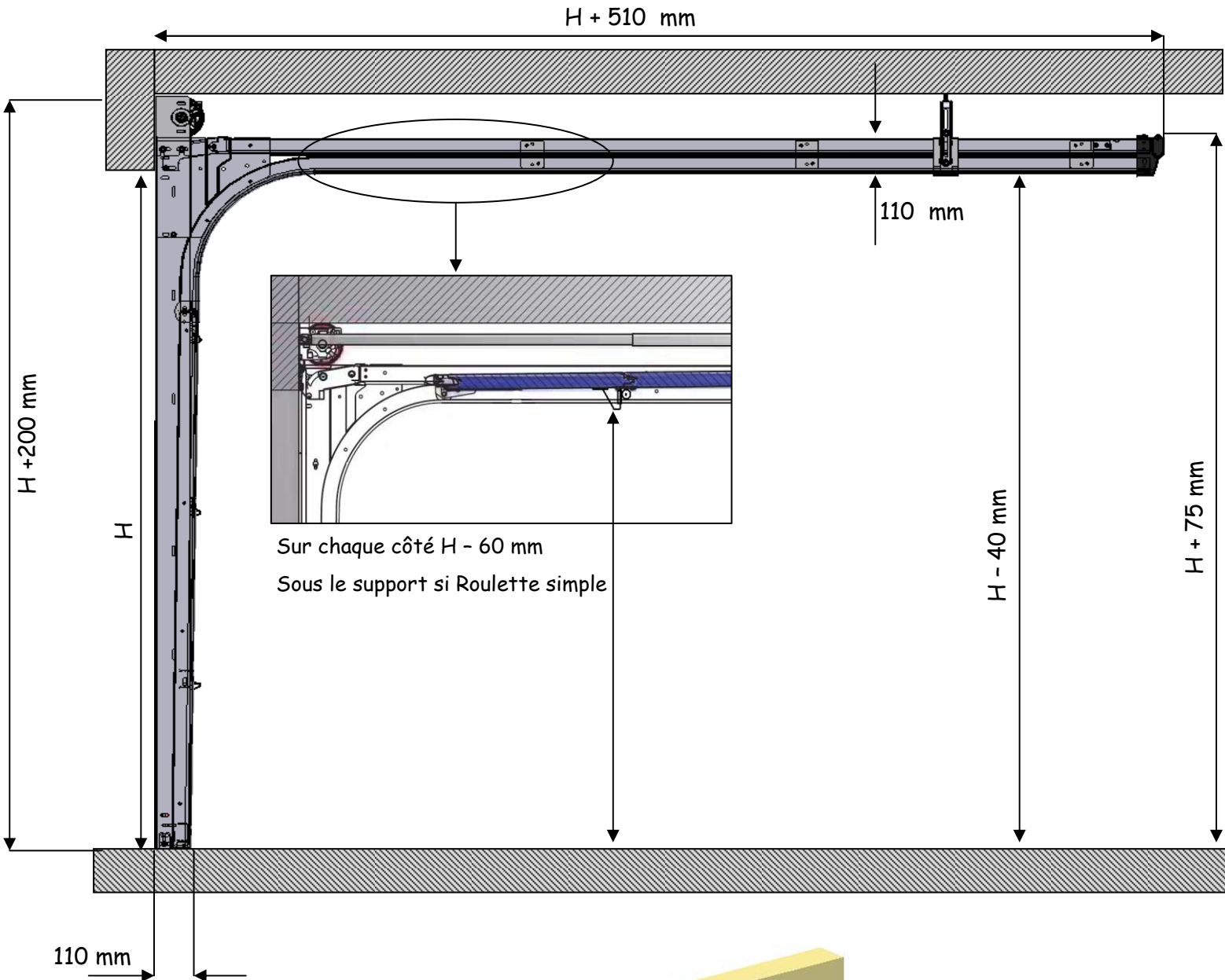
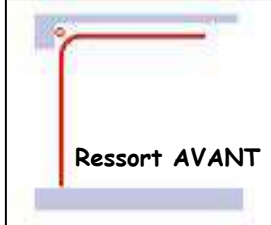
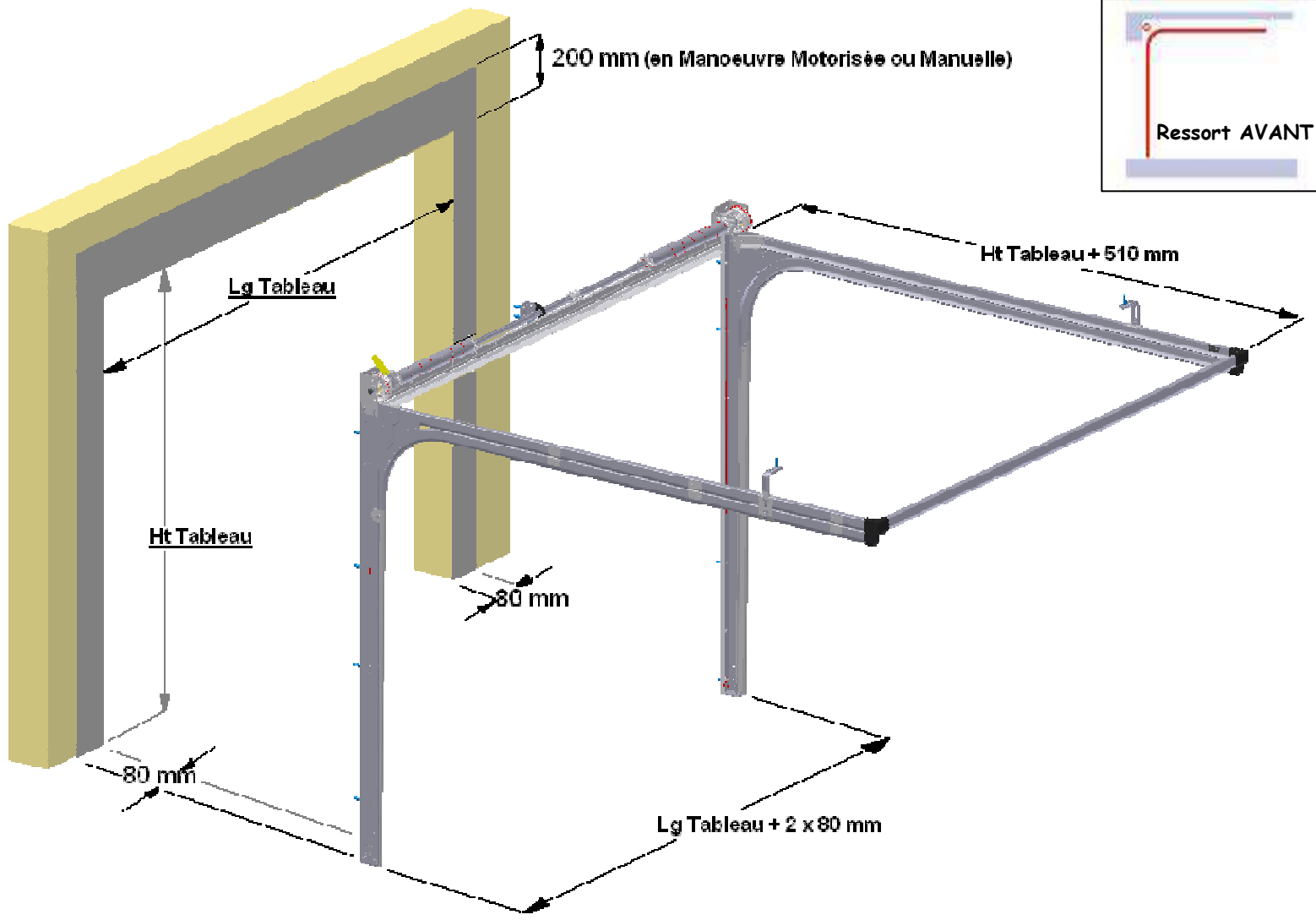

Les Maximums

- 1^{ère} combinaison :
Lg = 5000 mm x Ht = 3000 mm maximum
Ou
- 2^{ème} combinaison :
Lg = 5500 mm x Ht = 2500 mm maximum

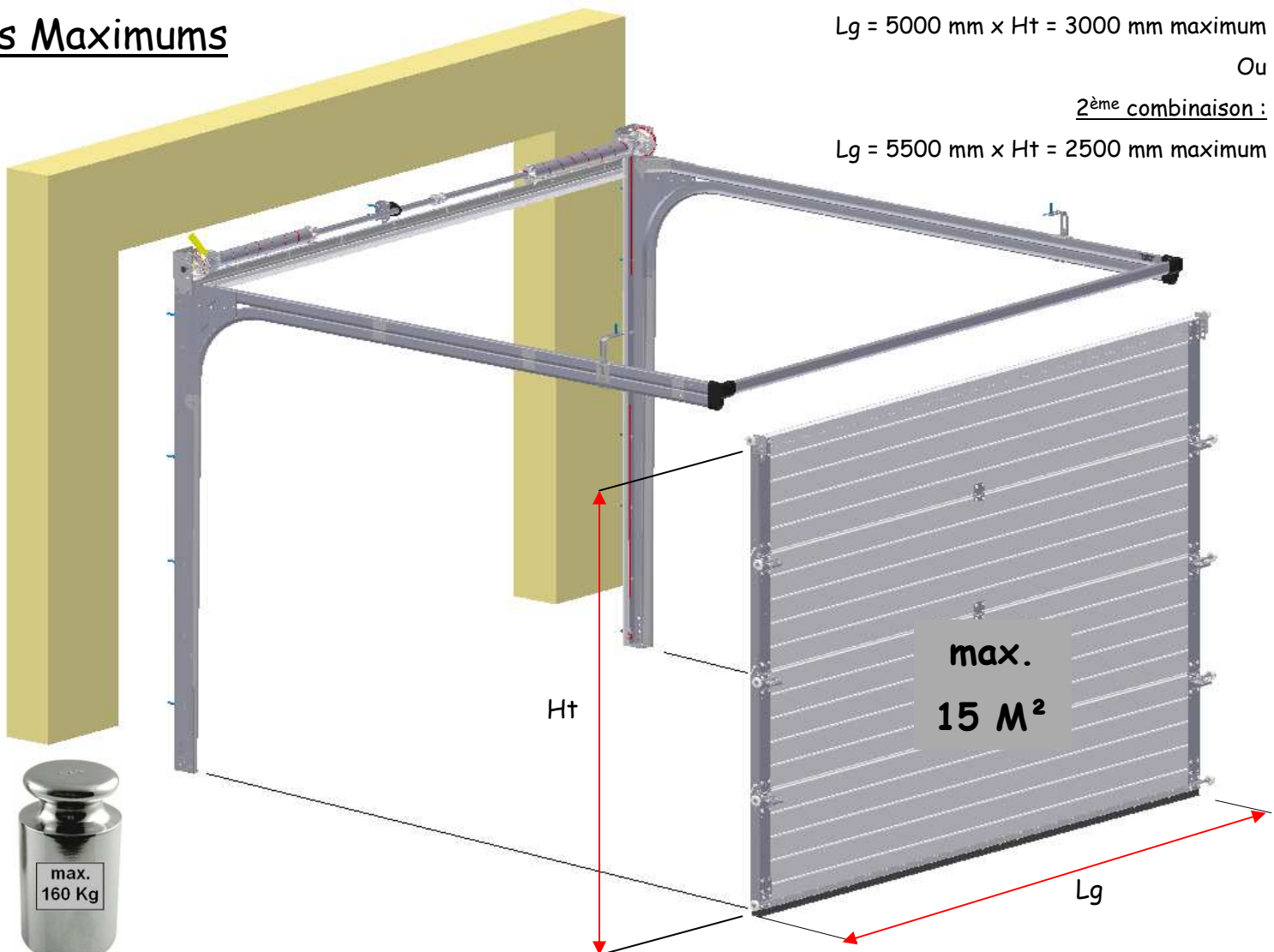

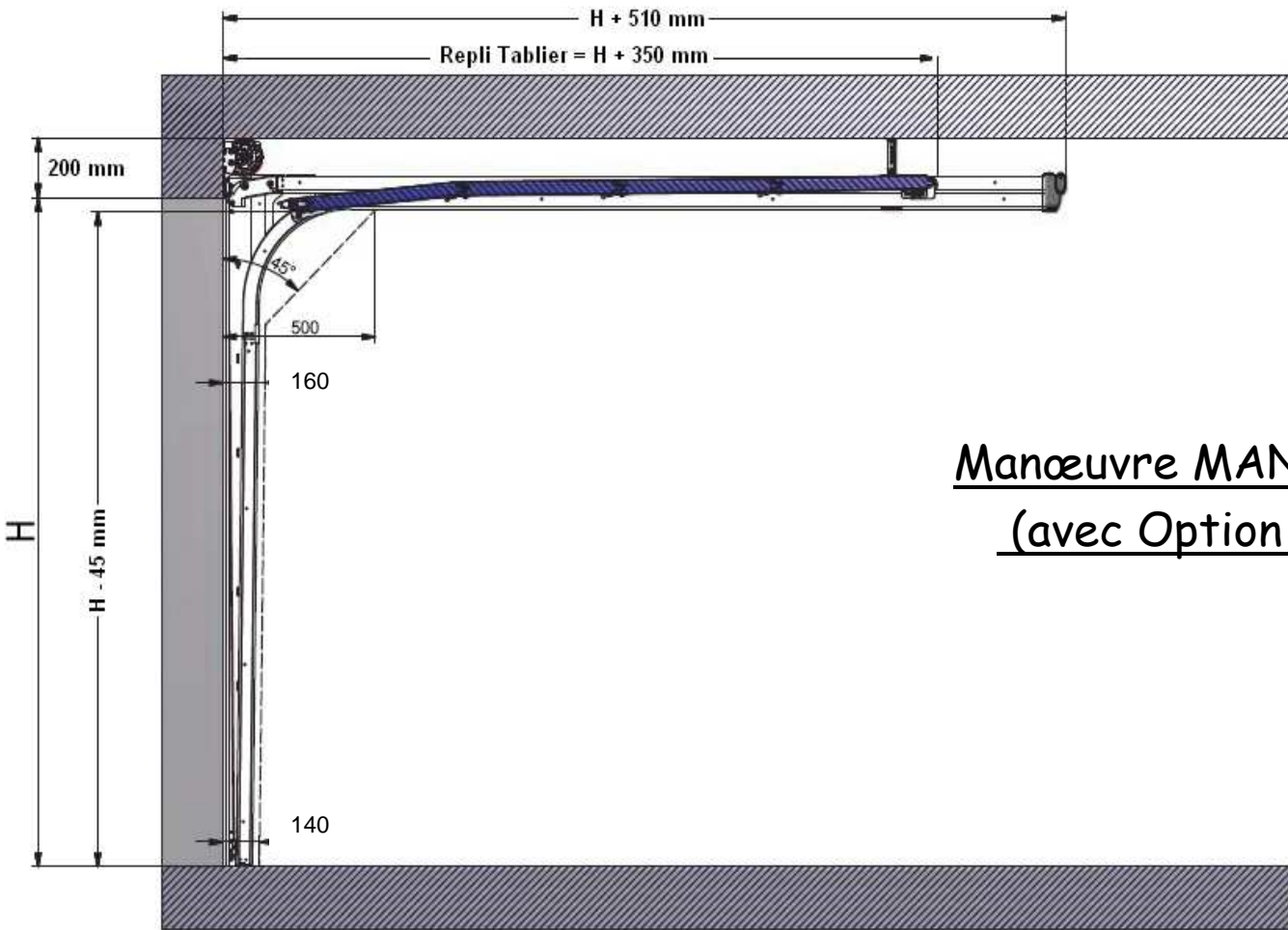

Manœuvre MANUELLE
(avec Option SER)

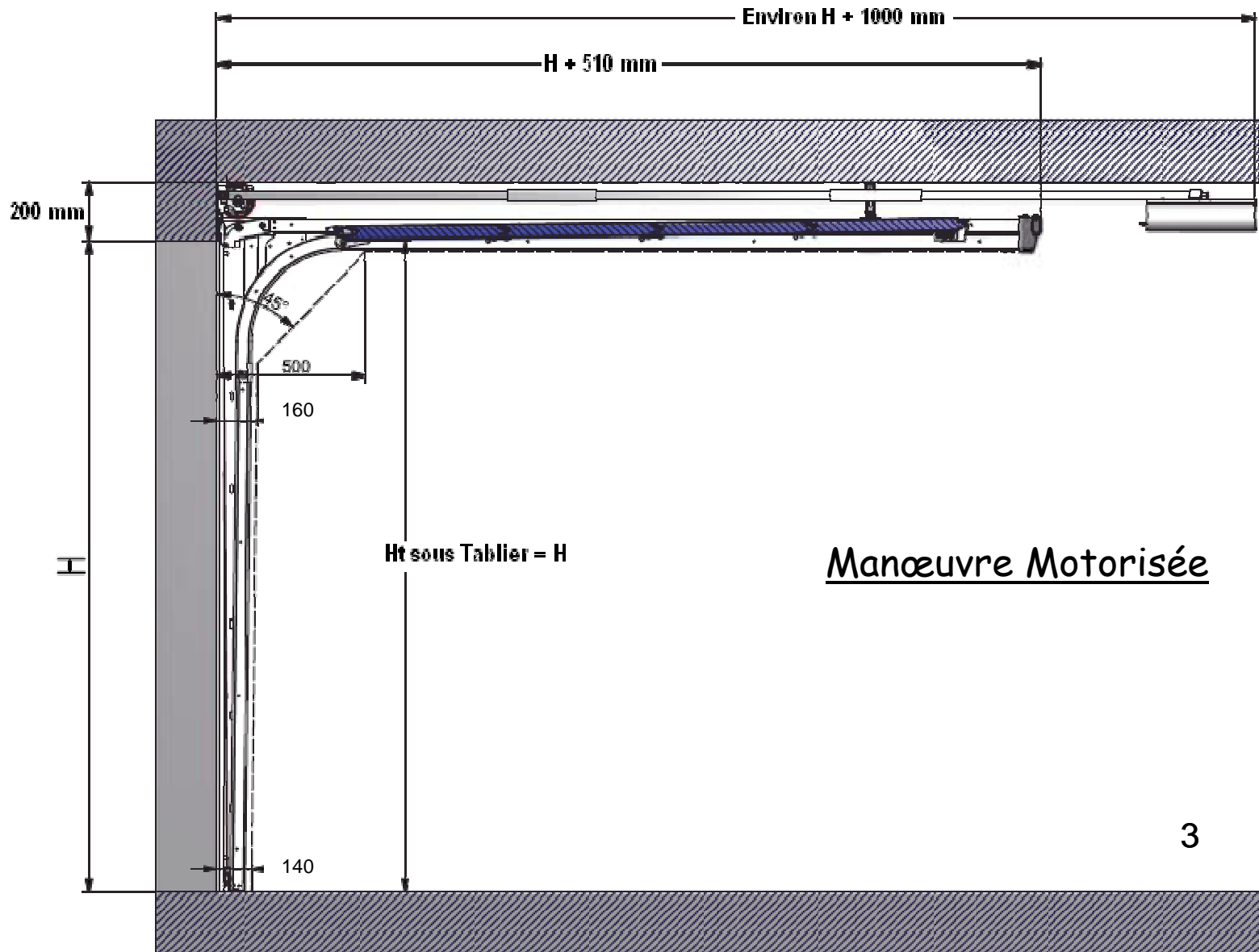

Manœuvre Motorisée

Réservations au sol - configuration Ressort AVANT

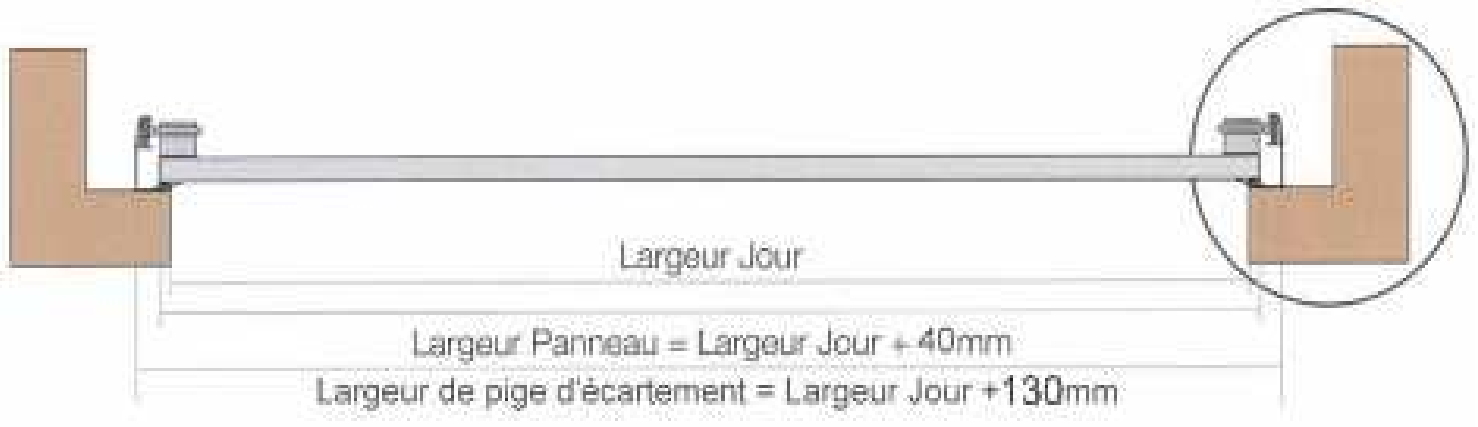
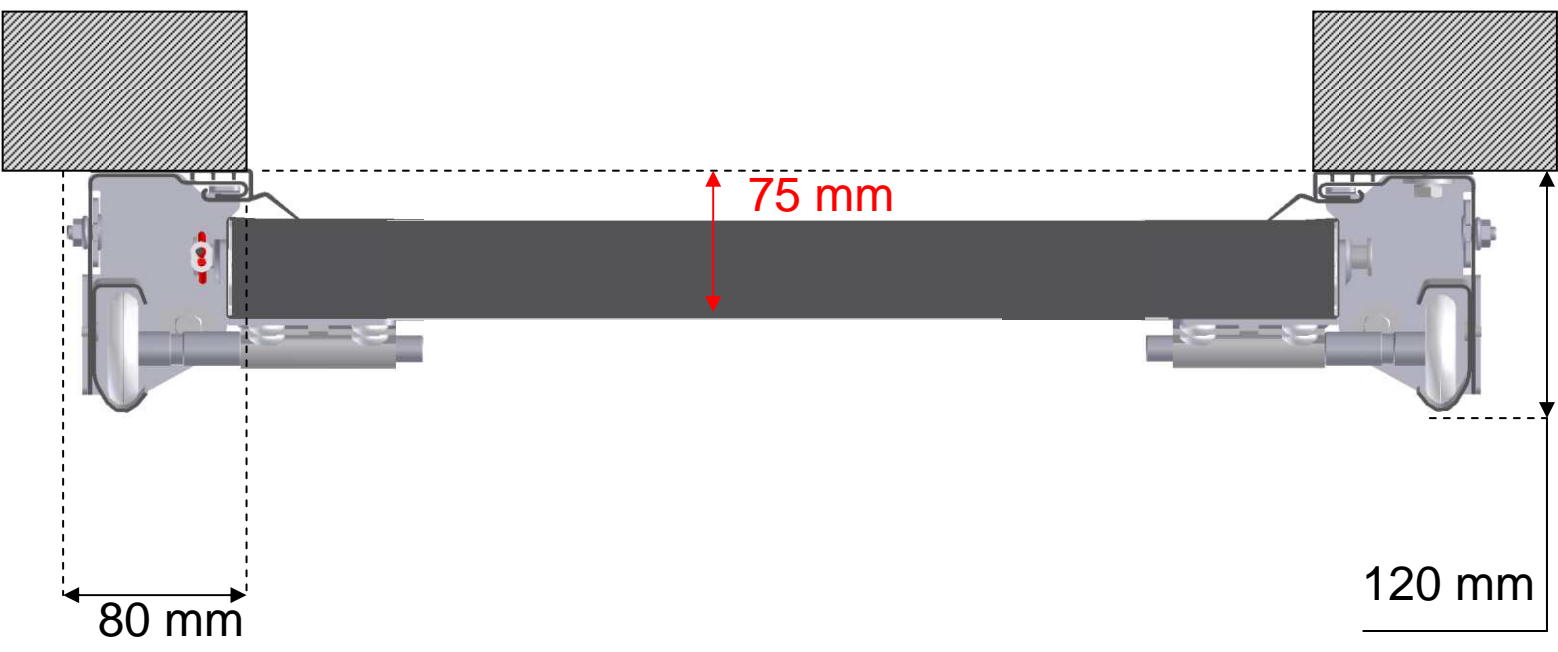

- X = 80 mm minimum
- A = 60 mm
- B = 2 mm
- C = 63 mm
- D = 59 mm

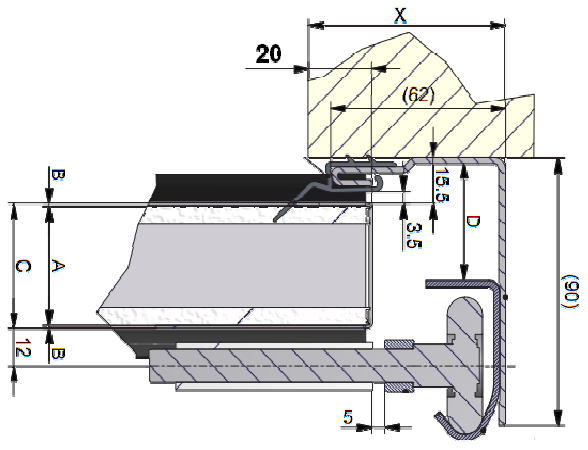

Les Encombrements - configuration Ressort ARRIERE

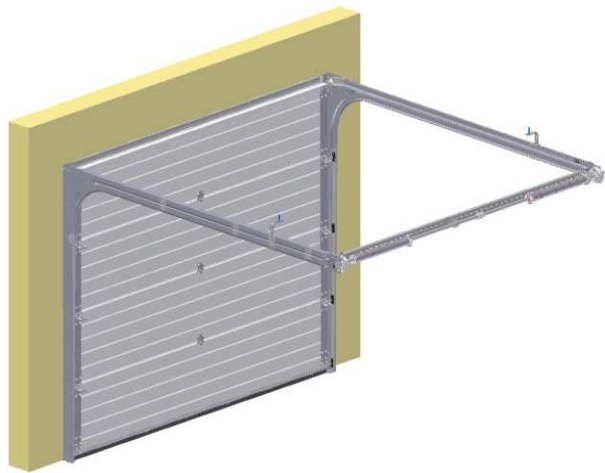
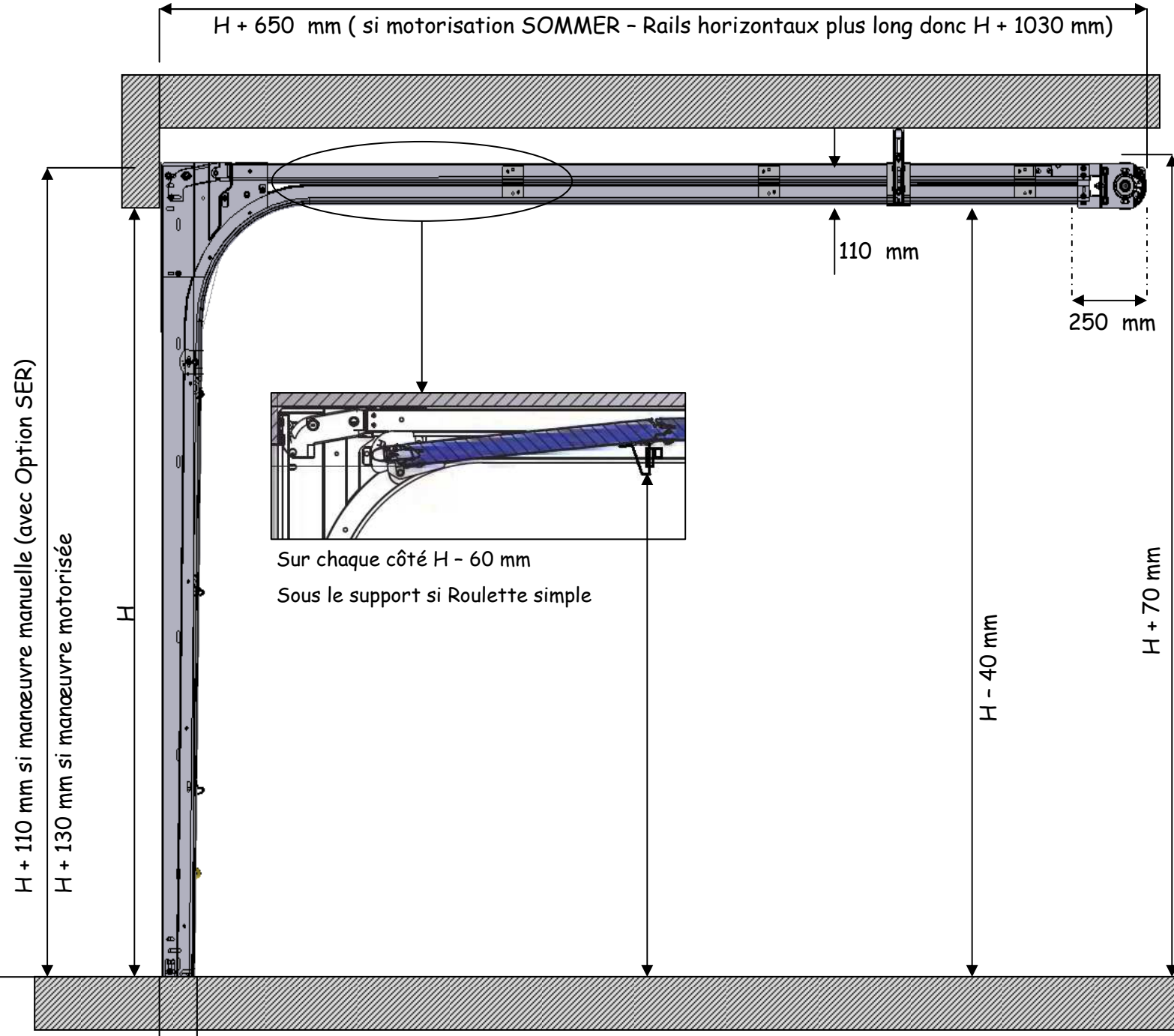

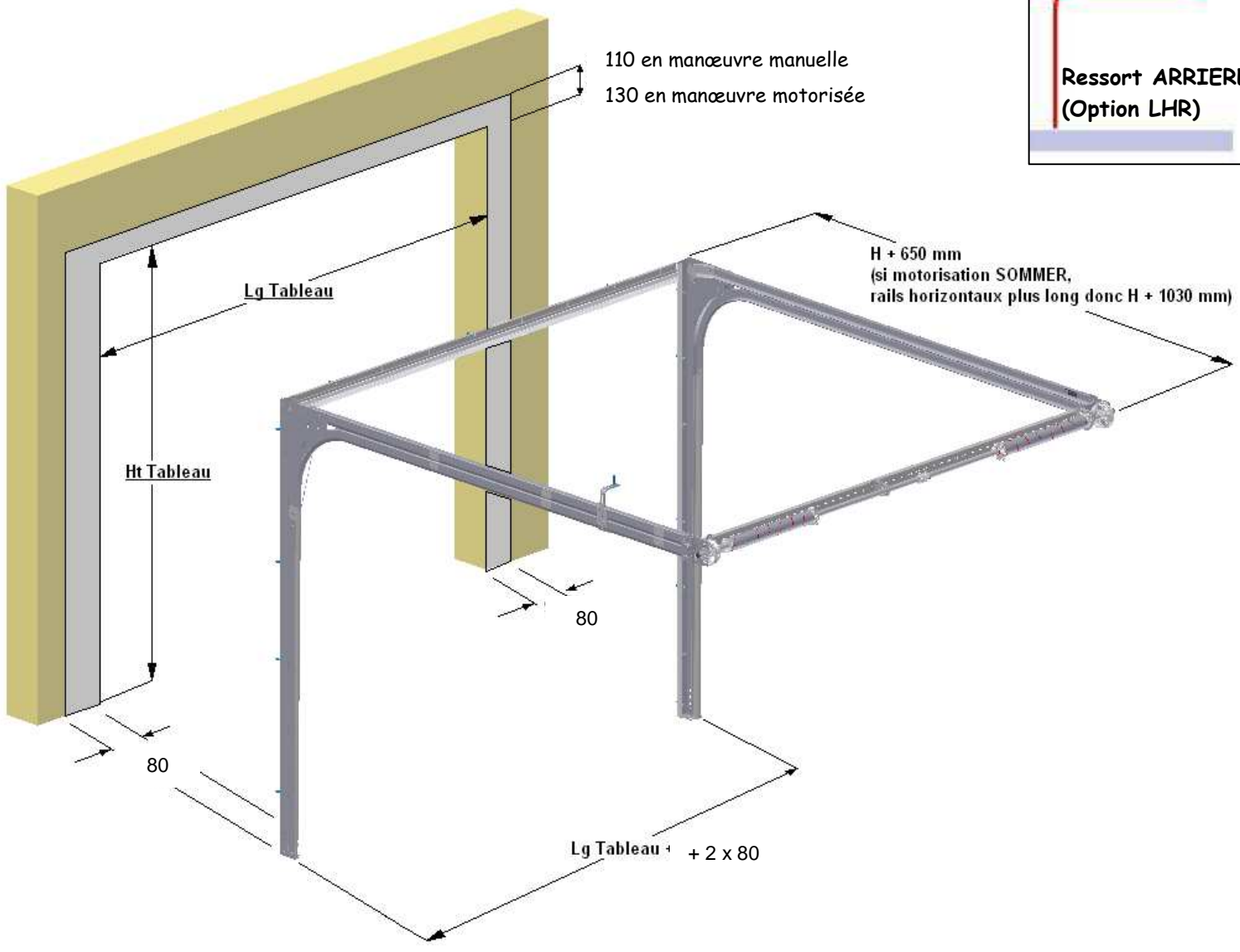

Les Maximums

1^{ère} combinaison :

Lg = 5000 mm x Ht = 3000 mm maximum
Ou

2^{ème} combinaison :

Lg = 5500 mm x Ht = 2500 mm maximum

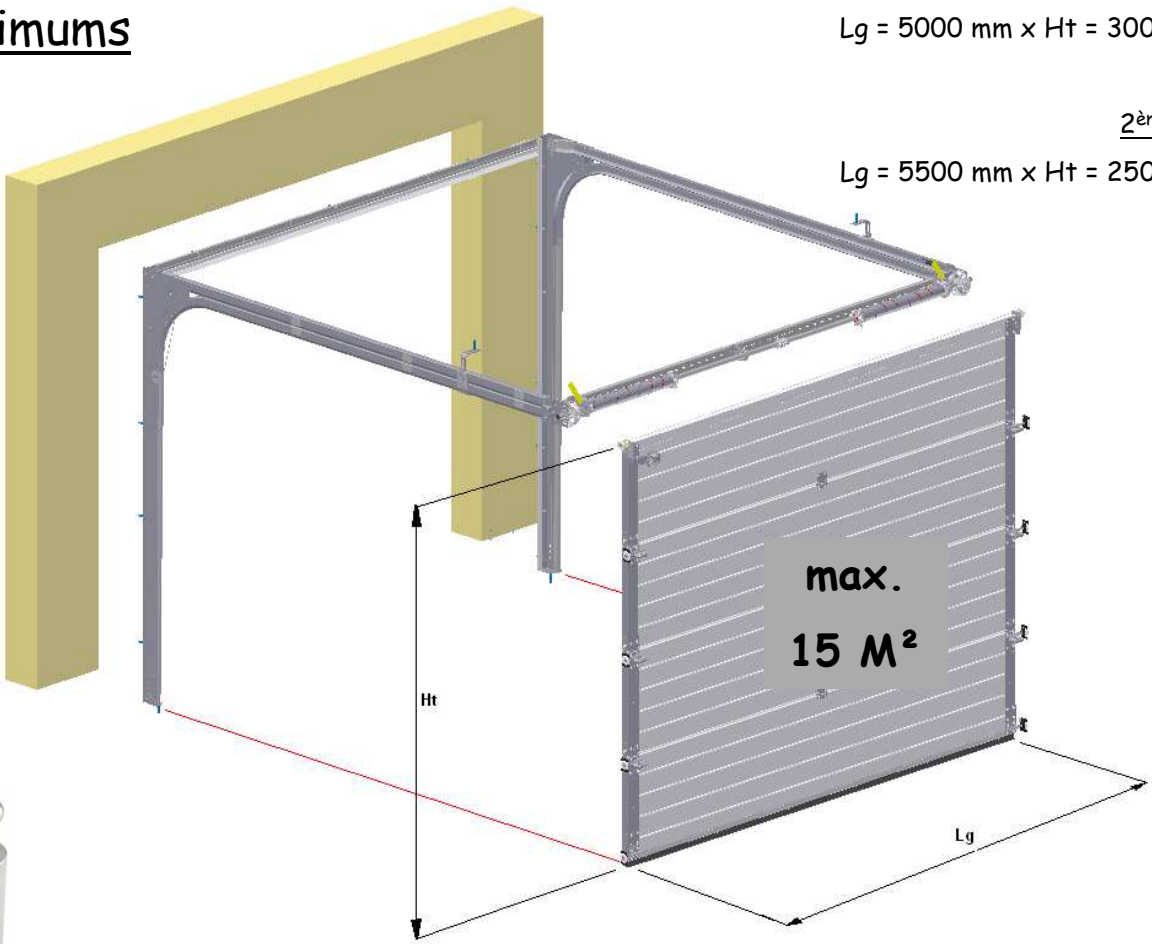

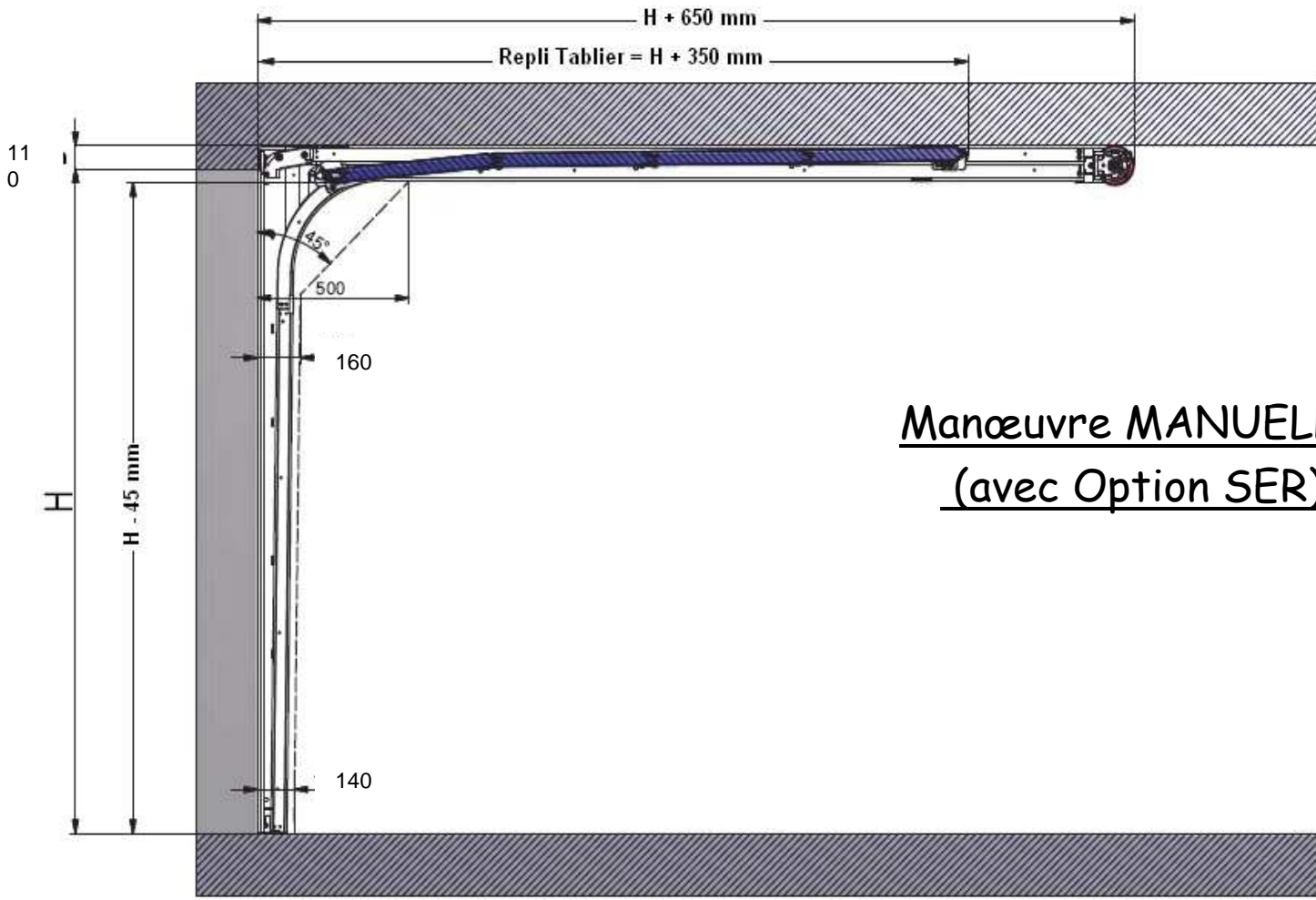

Manœuvre MANUELLE
(avec Option SER)

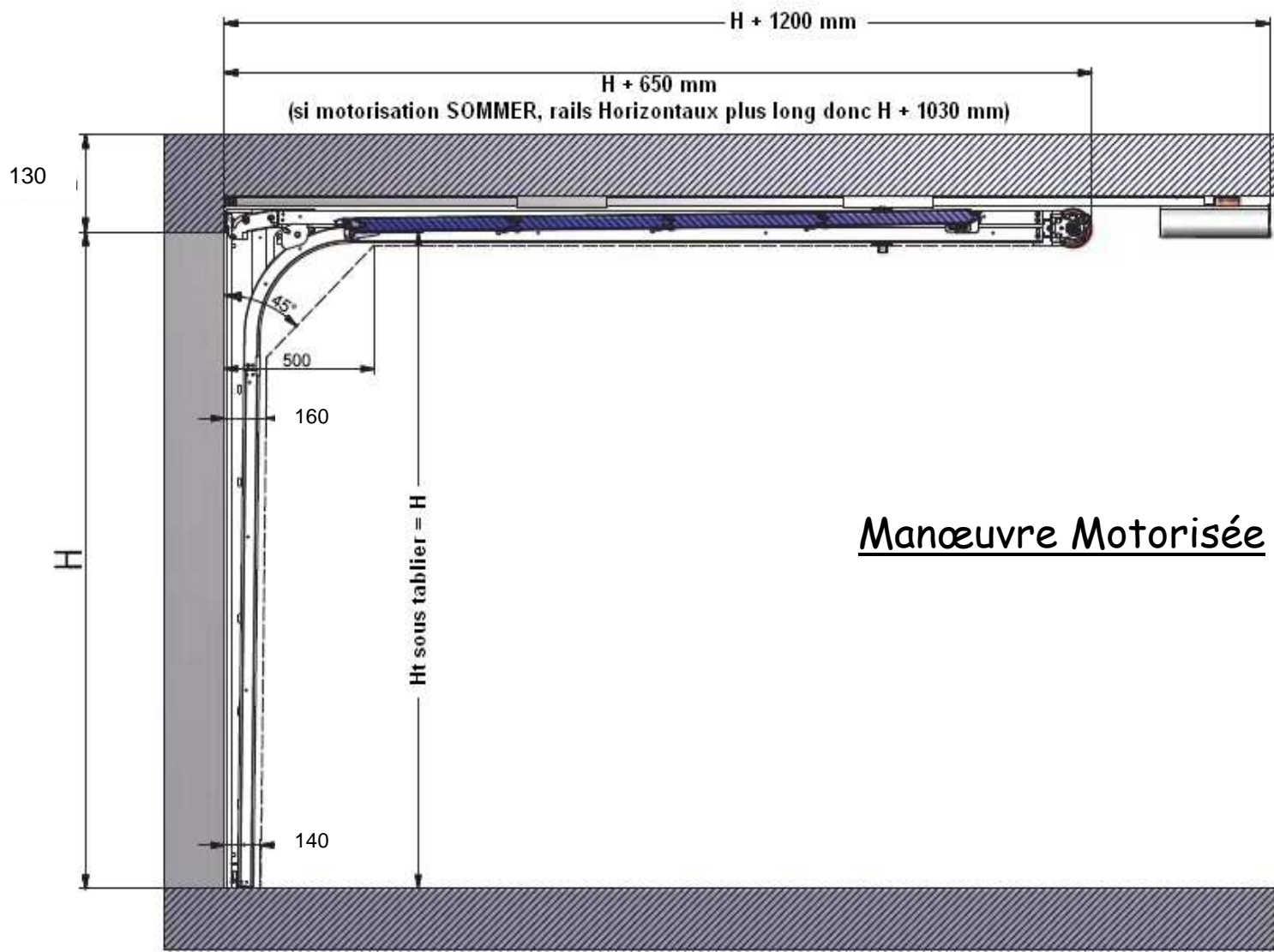

Manœuvre Motorisée

Réservations au sol - configuration Ressort ARRIERE

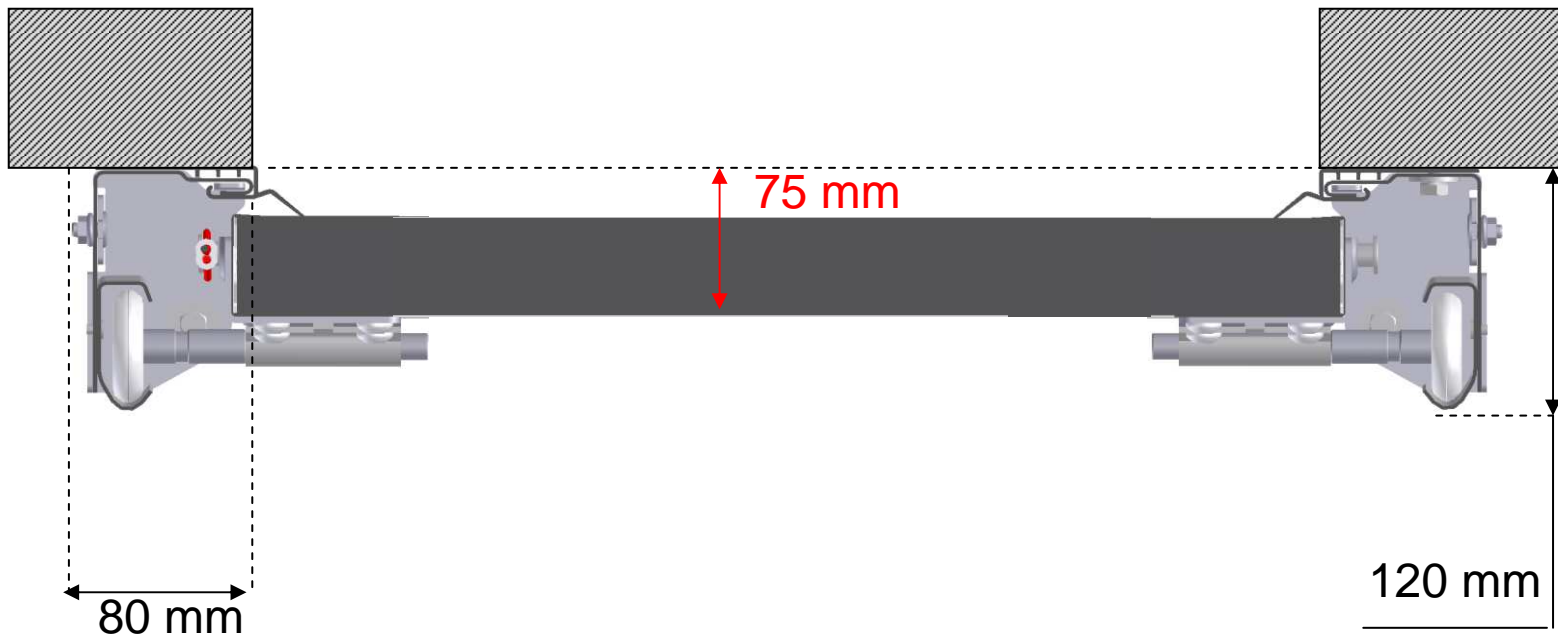

- X = 80 mm minimum
- A = 60 mm
- B = 2 mm
- C = 63 mm
- D = 59 mm

